

LOC		DIST		REVISIONS			
F	LTR	DATE	BY	APPD	REV	DESCRIPTION	DATE
E		4/21/05	SS	GS	1	REVISED PER 063B-0179-05	

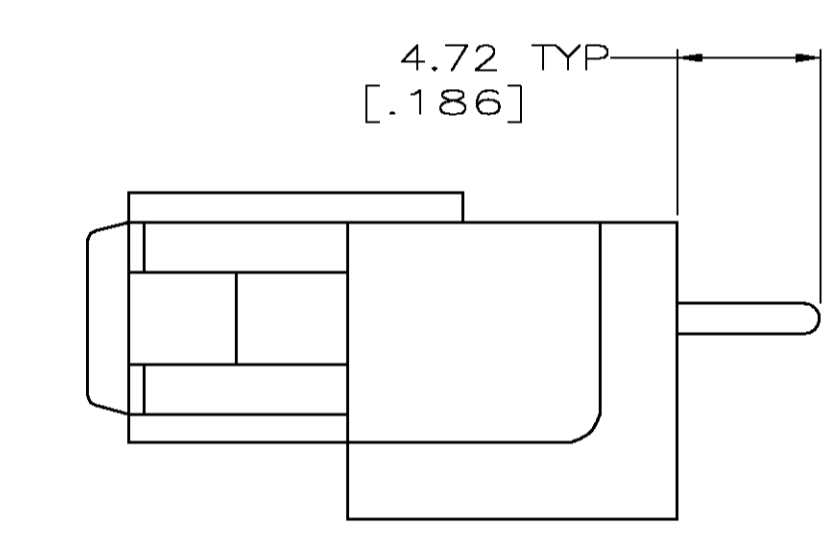

POWER CONTACT DETAIL

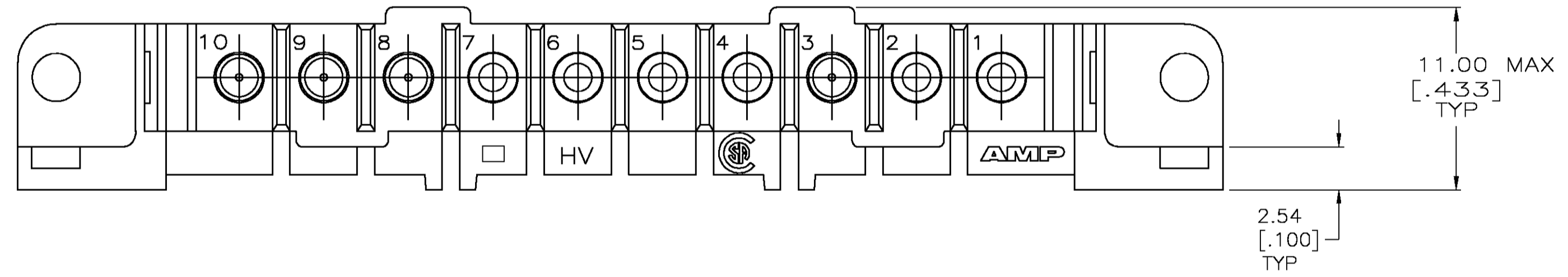
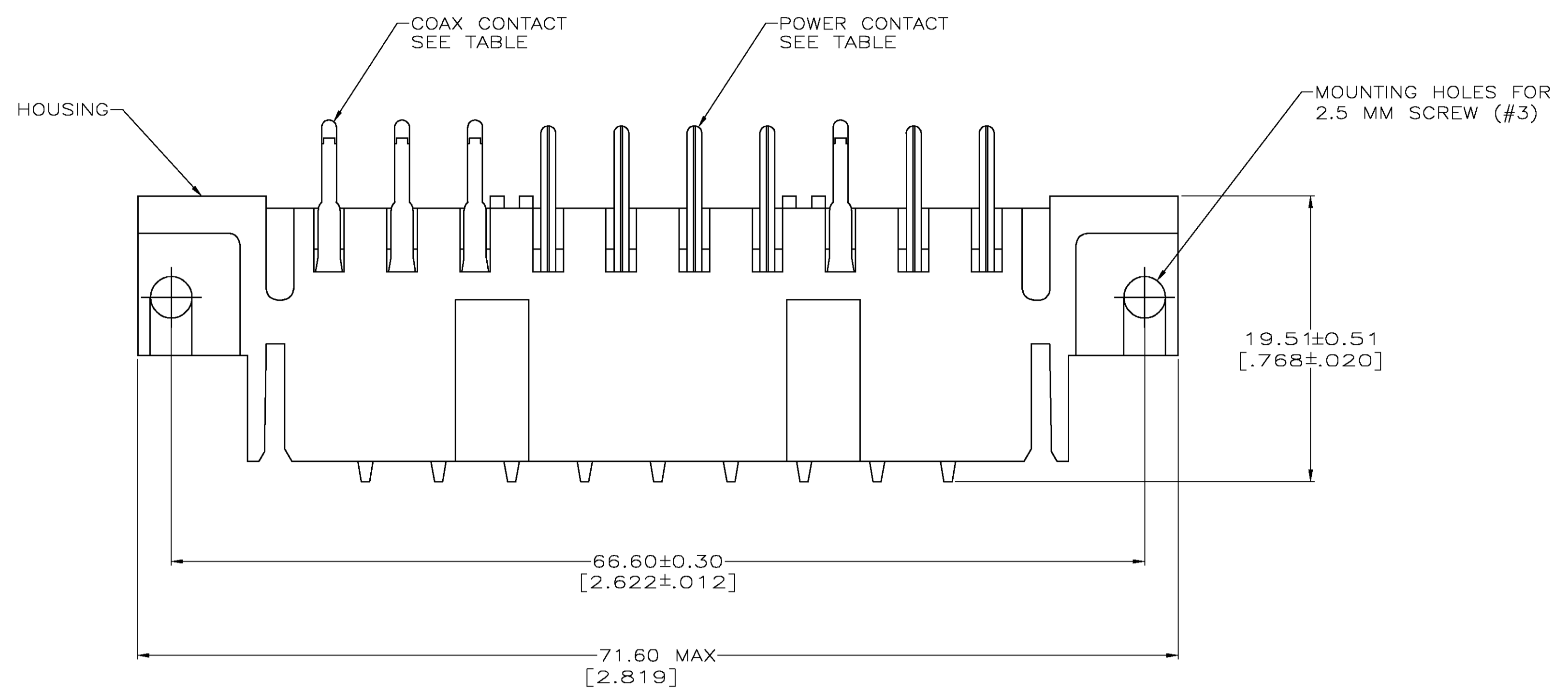
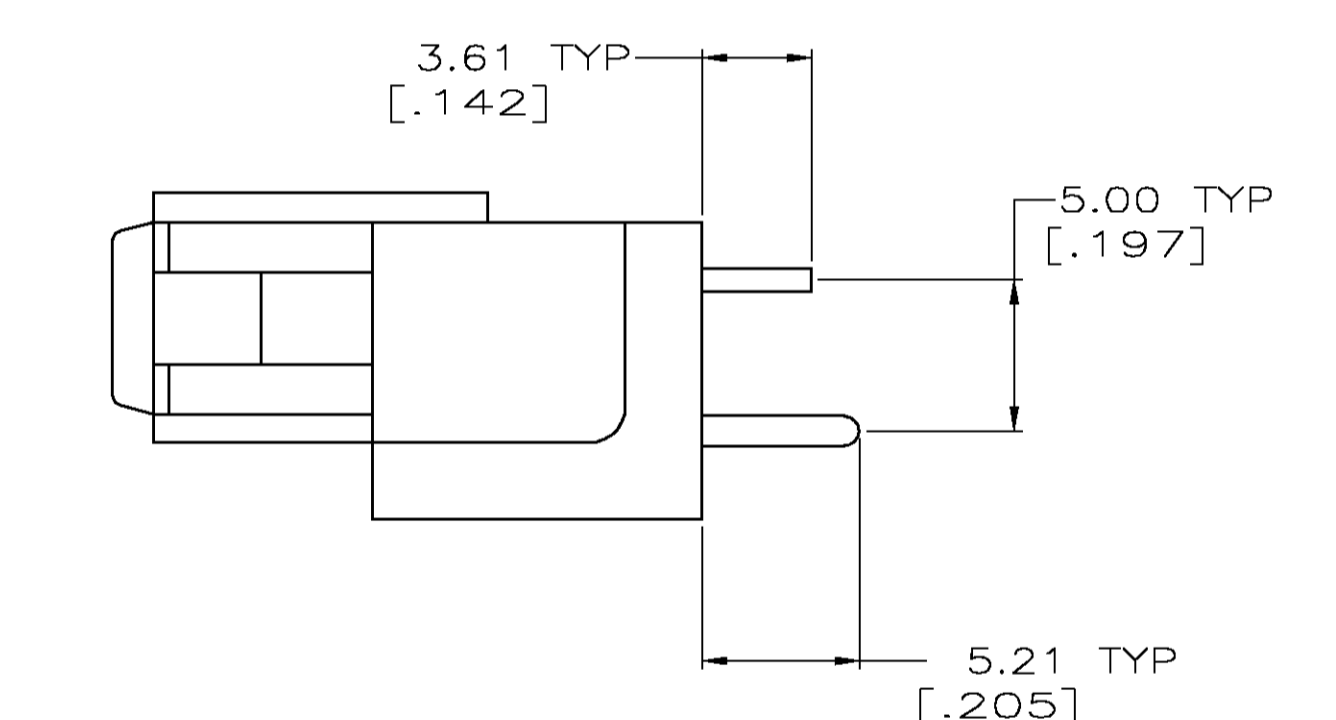

COAX CONTACT DETAIL

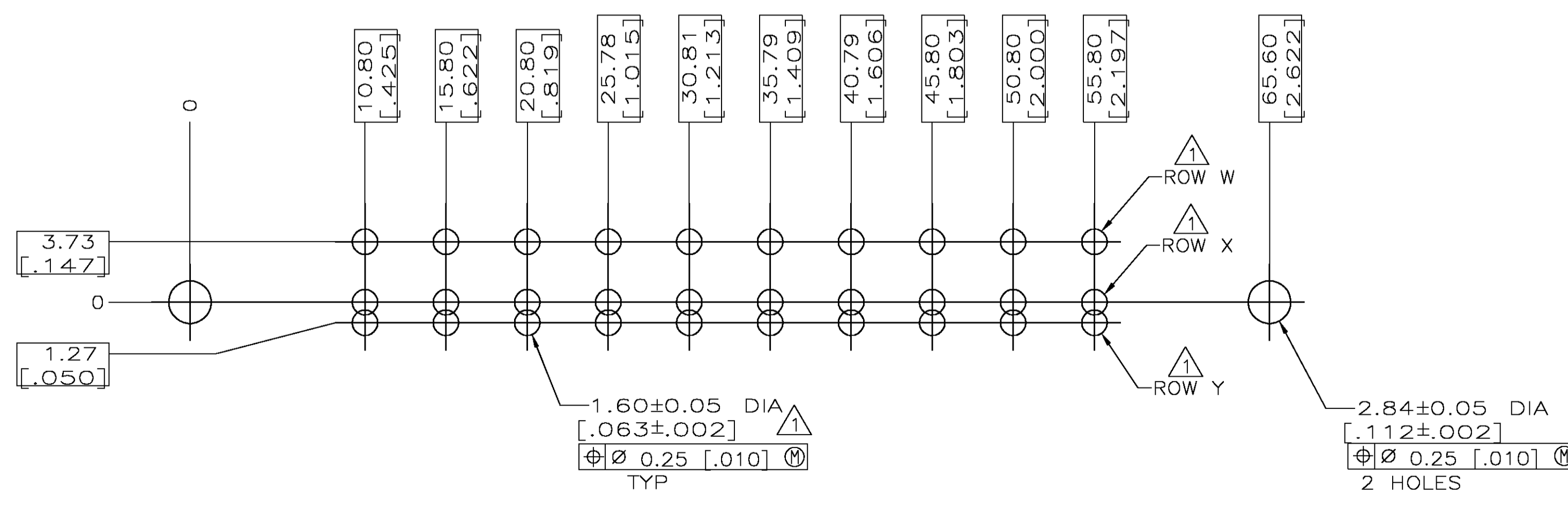

RECOMMENDED PC BOARD LAYOUT

- ⚠ HOLES LOCATED IN ROWS W & Y FOR ANY CIRCUIT WITH A COAX CONTACT. HOLES LOCATED IN ROW X FOR ANY CIRCUIT WITH A POWER CONTACT.
- ⚠ BODY: BRASS PER QQ-B-626. HOOD: STAINLESS STEEL PER QQ-S-766.
- ⚠ CENTER CONDUCTOR: BRASS PER QQ-B-626. SHELL: BRASS PER MIL-C-50.
- ⚠ 0.76um [.000030] MIN GOLD PER MIL-G-45204 FOR A LENGTH OF 5.08 [.200] MIN FROM MATING END, 3.81um [.000150] MIN TIN-LEAD PER MIL-T-10727 ON REMAINDER, BOTH OVER 1.27um [.000050] MIN NICKEL PER QQ-N-290.
- ⚠ CENTER CONDUCTOR: 1.27um [.000050] MIN GOLD PER MIL-G-45204 1.27um [.000050] MIN NICKEL PER QQ-N-290. SHELL: 0.38um [.000015] MIN GOLD PER MIL-G-45204 OVER 1.27um [.000050] MIN NICKEL PER QQ-N-290.
- ⚠ 0.76um [.000030] MIN GOLD PER MIL-G-45204 FOR A LENGTH OF 5.08 [.200] MIN FROM MATING END, 3.81um [.000150] MIN TIN PER MIL-T-10727 ON REMAINDER, BOTH OVER 1.27um [.000050] MIN NICKEL PER QQ-N-290.

TYPE OF CONTACTS LOADED	CTK #10	CTK #9	CTK #8	CTK #7	CTK #6	CTK #5	CTK #4	CTK #3	CTK #2	CTK #1	PART NO.
COAX	COAX	COAX	PWR	PWR	PWR	PWR	COAX	PWR	PWR		208309-3
COAX	COAX	COAX	PWR	PWR	PWR	PWR	COAX	PWR	PWR		208309-2
COAX	COAX	COAX	COAX	COAX	COAX	COAX	COAX	COAX	COAX		208309-1

THIS DRAWING IS A CONTROLLED DOCUMENT.		DWG: D.GELTZ	10/26/92	Tyco Electronics Corporation Harrisburg, Pa 17105-3608
DIMENSIONS: mm [INCHES]		CHK: R.STONE	12-18-92	
TOLERANCES UNLESS OTHERWISE SPECIFIED:		APVD: -		NAME: -
0 PLC ± -		PRODUCT SPEC: -		APPLICATION SPEC: -
1 PLC ± -		SIZE: -		CAGE CODE: -
2 PLC ± 0.25 [.010]		DRAWING NO: A1 00779		DRAWING NO: 208309
3 PLC ± -		WEIGHT: -		RESTRICTED TO: -
4 PLC ± -		CUSTOMER DRAWING		SCALE: 4:1
ANGLES: -		SHEET: 1 OF 1		REV: E